

**Joint Meeting of the Santa Fe River Springs Basin Working Group and
Fanning & Manatee Springs Working Group
AGENDA**

Wednesday, October 19, 2011 9:00 AM - 12:15 PM, with a field trip from 2:00 PM - 4:00 PM.
In High Springs at the Opera House (above the Great Outdoors Restaurant) 65 N. Main St.

**THEME - Evolving Agricultural Best Management Practices (BMPs):
Protecting Groundwater Flowing to Springs**

Time	Activity	Speaker
9:00	Welcome, Introductions, and Announcements	
9:45	Why Agricultural Practices Are Critical to Springs Protection	Stacie Greco - Coordinator, Santa Fe River Springs Basin Working Group Carol Lippincott - Coordinator, Fanning & Manatee Springs Working Group
10:00	Evolving Ag BMPs: Toward Less Nutrient Loss to Groundwater	Dell Bottcher - President, Soil and Water Engineering Technology
10:40	Evolving Ag BMPs: Toward Lower Use of Water	Richard Marella- Geographer, US Geologic Survey, Florida Lynn Torak - Hydrologist, US Geologic Survey, Georgia
11:30	Evolving Ag BMPs: A Grower's Perspective	Alto Straughn - Owner, Straughn Farms
12:10	Wrap Up	
12:15	Lunch Break - on your own!	
2:00	Meet at local peanut farm to learn about agricultural BMPs (directions on back of agenda)	Hugh Thomas - Suwannee River Partnership Kelly Philman- Local Producer Mace Bauer- Institute of Food and Agricultural Sciences, University of Florida
4:00	Adjourn	

See back for field trip directions!

Directions to Field Trip: Head SW on N Main Street (SR41) out of High Springs. Take a right on Poe Springs Rd (NW 182nd Ave/SR 340). Pass Poe, Blue, and Ginnie Springs. About 1/2 mile before you get to the SR 47 intersection, the farm entrance will be on the right. Please look for a Springs Working Group Meeting sign. If you get lost please call Stacie at 352-213-4979.

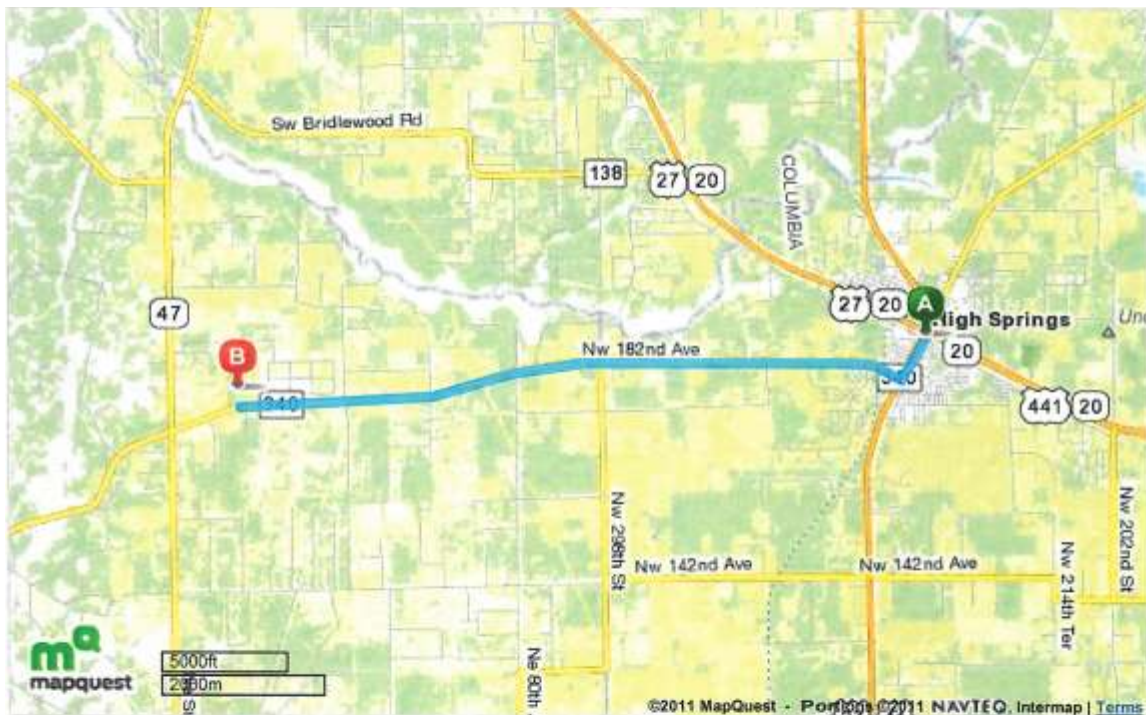

Thank you to the Great Outdoors Restaurant/Opera House Banquet Room for donating meeting space and coffee service for this meeting!